

INSTALLATION TOOLS REQUIRED:
TAPE MEASURE, MASKING TAPE, LEVEL, #2 PHILLIPS
SCREWDRIVER, FLAT SCREWDRIVER, DRILL WITH 1/8",
1/64" AND 3/16" BITS, HACKSAW, PENCIL, CLEAR
SILICONE CAULKING.

OPTIONAL: MITER BOX, FILE, AND CENTER-PUNCH.

1. MEASURE THE WALL-TO-WALL OPENING AT THE CENTER OF THE TUB RIM OR SHOWER CURB. CUT THE TRACK (A) 1/16" SHORT OF THIS DIMENSION. CENTER THE TRACK AS SHOWN AND USE MASKING TAPE TO MARK THE EDGES AND SECURE TO THE TUB OR SHOWER.

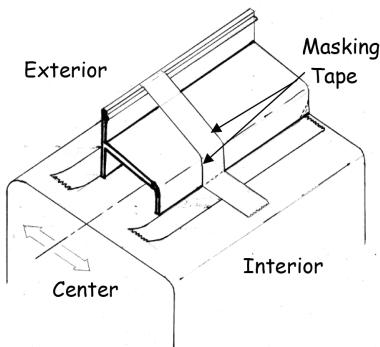

3. REMOVE THE PARTS AND DRILL 1/8" HOLES APPROXIMATELY 1 INCH DEEP IN EACH WALL IN THE MARKED LOCATIONS. IN TILE OR MARBLE WALLS, IT MAY BE NECESSARY TO DRILL 3/16" HOLES AND INSERT THE PLASTIC WALL PLUGS (C). USING A CAULKING GUN AND A GOOD GRADE OF SILICONE, RUN TWO CONTINUOUS BEADS OF SEALANT INSIDE THE MASKING TAPE AND INSIDE THE CORNERS. TO ENSURE A TIGHT FIT, FORCE A SLIGHT DOWNWARD BOW IN THE TUB TRACK. CAREFULLY REPLACE THE TRACK AND PRESS FIRMLY INTO THE SEALANT.

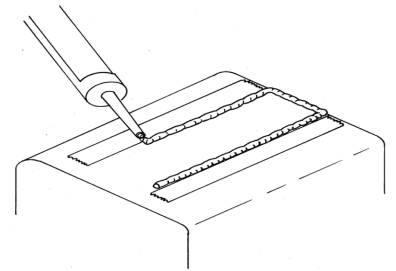

2. NOTE: THE WALL JAMBS ARE LABELED "INSIDE" AND "OUTSIDE". INSTALL THE "INSIDE" JAMB ON THE SIDE OF THE ENCLOSURE CLOSEST TO THE SHOWER HEAD AND THE "OUTSIDE" JAMB ON THE SIDE AWAY FROM THE SHOWER HEAD. PRESS THE APPROPRIATE JAMB OVER THE ENDS OF THE TRACK. PLUMB THE WALL JAMBS WITH A LEVEL AND SECURE WITH MASKING TAPE. USE A PENCIL TO MARK THE LOCATIONS OF THE THREE HOLES IN EACH WALL JAMB. IF NECESSARY, USE A FILE TO ROUND THE CORNERS OF THE WALL JAMBS AND TRACK TO MATCH THE WALL CONDITIONS.

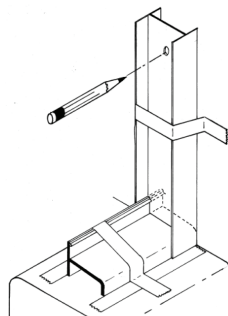

4. REPLACE ONE WALL JAMB AND ATTACH TO THE WALL BY PRESSING A NYLON SPACER (E) OVER TWO #8 X 1-1/2" TRUSS HEAD SCREWS (D) AND INSERT THROUGH THE TOP AND BOTTOM HOLES. INSTALL A THIRD SCREW IN THE CENTER HOLE. CHECK FOR PLUMB BEFORE TIGHTENING THE SCREWS. REPEAT FOR THE OTHER WALL JAMB. WALL JAMB CAPS (F) ARE MARKED FOR SHOWER LEFT OR SHOWER RIGHT INSTALLATION. LOCATE THE CORRECT CAPS AND PRESS INTO PLACE. DISCARD THE REMAINING CAPS. MEASURE THE WALL-TO-WALL OPENING AT THE TOP OF THE WALL JAMBS. CUT THE HEADER (G) 1/16" SHORT OF THIS DIMENSION AND CHECK FOR FIT. SLIDE THE HEADER OVER THE WALL JAMBS UNTIL THE HEADER TRACKS REST ON THE END OF EACH JAMB.

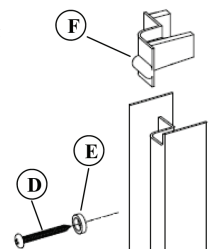

5. ATTACH A ROLLER BEARING (H) TO A HANGER BRACKET (I) WITH A #8-32 X 3/8" HEX WASHER HEAD SCREW (J) AS SHOWN. MAKE SURE THE BEARING IS LOCATED ON THE SIDE OF THE FIN WITH A RECESS AS SHOWN IN THE ILLUSTRATION.

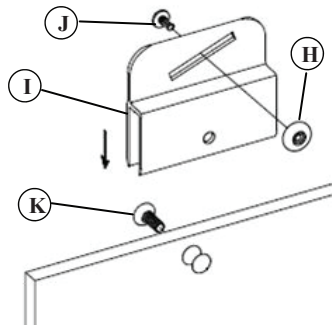

SLIDE THE BRACKET OVER THE DOOR PANEL AND INSERT A 1/4" X 5/8" FLAT HEAD MACHINE SCREW (K) THROUGH THE BRACKET, THE HOLE IN THE GLASS DOOR PANEL AND THREAD INTO THE OPPOSITE SIDE OF THE BRACKET. TIGHTEN SECURELY. REPEAT THIS PROCEDURE FOR THE REMAINING THREE BRACKETS.

6. FOR UNITS GLAZED WITH OBSCURE GLASS, IDENTIFY THE INTERIOR AND EXTERIOR PANELS. ROLLERS ON THE EXTERIOR PANEL ARE INSTALLED ON THE SAME SIDE AS THE TEXTURED SURFACE OF THE GLASS. ROLLERS ON THE INTERIOR PANEL ARE INSTALLED ON THE SMOOTH SIDE OF THE GLASS. FOR EASE OF CLEANING, OBSCURE GLASS IS ALWAYS INSTALLED WITH THE TEXTURED SURFACE TO THE EXTERIOR OF THE UNIT. STANDING OUTSIDE THE TUB OR SHOWER, LIFT THE INTERIOR PANEL INTO THE HEADER AS SHOWN AND POSITION THE ROLLERS INTO THE TRACK IN THE HEADER. REPEAT FOR THE EXTERIOR PANEL. CHECK FOR EASE OF OPERATION AND DETERMINE IF THE PANELS ARE PARALLEL TO THE WALL JAMBS. IF THE PANEL DOES NOT LINE UP WITH THE WALL JAMB, REMOVE AND ADJUST THE ROLLERS IN THE DIAGONAL SLOT FOR PROPER ALIGNMENT.

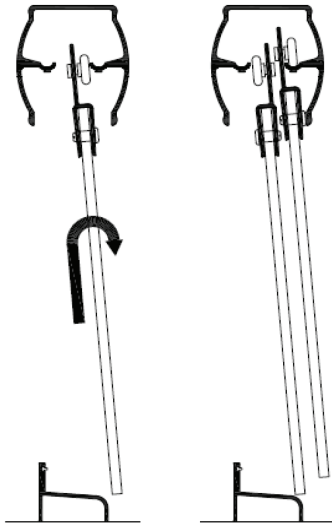

7. PLACE A PLASTIC BUSHING (L) INTO ONE TOWEL BAR HOLE THEN PLACE A PLASTIC WASHER (M) AGAINST THE GLASS. PLACE THE TOWEL BAR (N) AGAINST THE PLASTIC WASHER THEN PLACE ANOTHER WASHER OVER THE THREADED END OF A TOWEL BAR CAP AND INSERT THE THREADED END OF THE TOWEL BAR CAP (O) THROUGH THE BUSHING INTO THE THREADED INSERT IN THE TOWEL BAR. USE AN ALLEN WRENCH IN THE TOWEL BAR CAP TO TIGHTEN. REPEAT FOR THE OTHER END OF THE TOWEL BAR. REPEAT THIS ENTIRE PROCEDURE FOR THE SECOND TOWEL BAR.

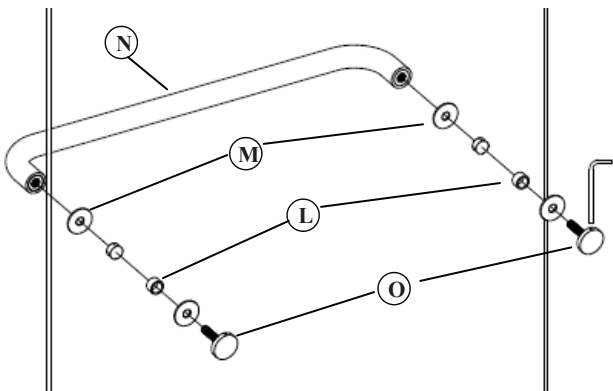

8. NOTE: THERE ARE 4 BUMPERS (P) LABELED 'L' FOR INSTALLATIONS WITH THE SHOWER HEAD ON THE LEFT AND 4 BUMPERS LABELED 'R' FOR INSTALLATIONS WITH THE SHOWER HEAD ON THE RIGHT. SELECT THE PROPER 4 BUMPERS AND INSTALL BY PRESSING THE LOWER PORTION OF THE 'KEYWAY' OVER THE HEAD OF THE SCREW AND SPACERS INSTALLED IN STEP #4 AND PRESSING DOWN. IF THE PANEL THAT DOES NOT SLIDE INTO THE RECESS IN THE JAMB HITS THE JAMB DUE TO OUT-OF-PLUMB CONDITIONS, A SELF-ADHESIVE BUMPER (Q) MAY BE APPLIED TO THE BOTTOM OF THE JAMB AND IN LINE WITH THE GLASS DOOR TO PREVENT THE GLASS FROM HITTING THE JAMB.

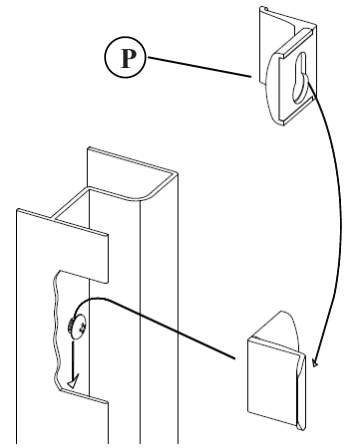

9. LOCATE A BOTTOM GUIDE (R) IN THE CENTER OF THE TRACK WITH THE INTERIOR PANEL POSITIONED AS SHOWN. DRILL A MOUNTING HOLE IN THE TRACK WITH A 7/64" BIT USING THE HOLE IN THE GUIDE AND THE V-GROOVE IN THE TRACK TO LOCATE PROPERLY. ATTACH WITH A #6 X 3/8" PAN HEAD SCREW (S). OPTIONALLY YOU MAY ALSO LOCATE A GUIDE IN THE CENTER OF EACH DOOR OPENING USING THE SAME PROCEDURE.

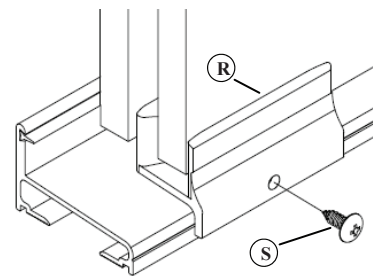

10. USING A CAULKING GUN (STEP #3) RUN A BEAD OF CLEAR SILICONE ALONG THE INTERIOR OF THE WALL JAMBS AND TRACK AS SHOWN. SEAL THE INTERSECTION OF THE WALL JAMBS AND THE TRACK AS SHOWN. ALLOW THE SILICONE TO DRY FOR 24 HOURS BEFORE USE.

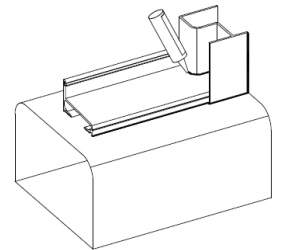

CLEAN YOUR NEW WATERFALL ENCLOSURE WITH A SOFT CLOTH AND A NON-ABRASIVE CLEANER WITH A NEUTRAL PH. DO NOT USE ACID BASED CLEANERS, VINEGAR OR SCOURING PADS TO CLEAN YOUR UNIT.



WATERFALL
BATH ENCLOSURES

www.waterfallbathenclosures.com